

## 670 W. Diversey Parkway Clark and Diversey, Chicago, Illinois



### Description

- 4,260 square feet available
- Existing restaurant with outdoor seating
- Planned façade renovation
- Located in Lakeview at the intersection of Clark and Diversey, one of the fastest growing retail markets
- Surrounded by national and local retailers as well as newly developed, high-end residential buildings
- Minutes from DePaul University, CTA Brown Line stop and various bus lines
- Affluent population of 83,000 people in 1-mile radius

### Demographics

Miles	Population	Av. HHI
0.25	7,900	\$100,000
0.5	31,000	\$95,000
1	83,000	\$111,000

### Area Retailers

Express	Akira
Ann Taylor LOFT	Trader Joe's
Urban Outfitters	Kuma's Too

### Leasing Inquiries:

**Kristen L. Martin**

[kmartin@newcastlelimited.com](mailto:kmartin@newcastlelimited.com)

312.252.1418

[www.newcastlelimited.com/retail](http://www.newcastlelimited.com/retail)

## 670 W. Diversey Parkway Clark and Diversey, Chicago, Illinois

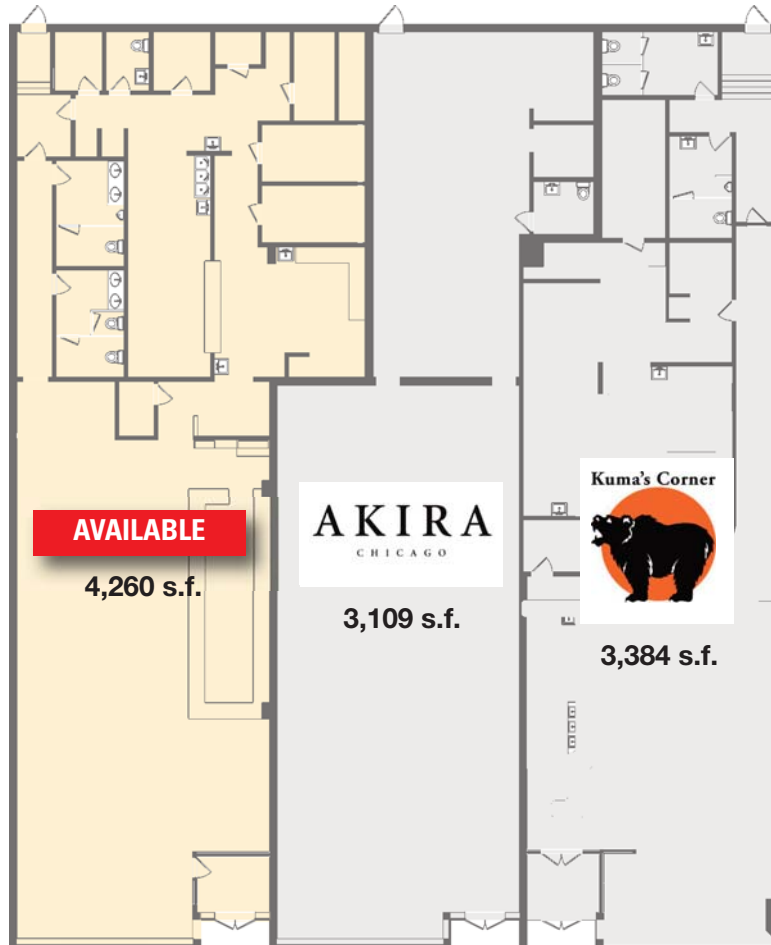

**W. Diversey Pkwy: 17,000 VPD**

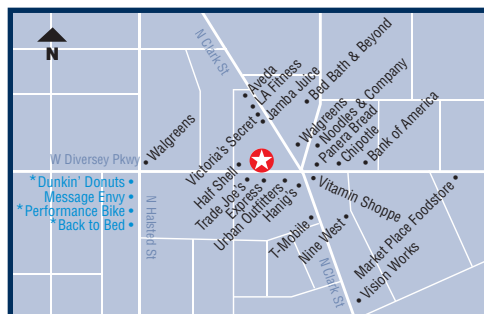

\* Newcastle Portfolio Properties

**Leasing Inquiries:**  
**Kristen L. Martin**  
kmartin@newcastlelimited.com  
312.252.1418  
www.newcastlelimited.com/retail

Newcastle Limited  
150 North Michigan Avenue  
Suite 3610  
Chicago, IL 60601  
312.252.1400  
www.newcastlelimited.com