

logan art gallery

Solo Exhibition Proposal Information pack and application form



The following documents aim to assist potential exhibiting artists by providing clear guidelines about how to apply for an exhibition at Logan Art Gallery. Additional information can be found in the document **TIPS for Producing an Effective Exhibition Proposal**, which is available for download from the website or by contacting the gallery.

Guidelines

Logan Art Gallery accepts proposals all year round from interested artists. Your proposal should reflect the selection criteria (see below). Please note: generally each artist may submit only one proposal every two years due to popular demand on exhibition spaces.

Please read the information pack and application carefully. If you require assistance completing your application form, require an interpreter, or would like to discuss your exhibition proposal, please contact the Exhibitions Officer or Cultural Services Program Leader at Logan Art Gallery.

General information

About Logan Art Gallery

Logan Art Gallery is situated on the corner of Wembley Road and Jacaranda Avenue, Logan Central. It comprises five exhibition spaces, a gallery store and a large public programs workshop area and courtyard. The gallery holds exhibitions by local and national artists as well as curated and touring shows. Practical workshops and various public programs including artist floor talks are held over the entire year.

Gallery hours: 10 am - 5 pm, Tuesday to Saturday.

Selection criteria

Proposals are invited from artists that:

- are conceptually refined and able to clearly communicate the exhibition idea/ theme
- are innovative
- are proposing technically resolved works.



Funding information

Logan Art Gallery provides artists with a high quality exhibition space, experienced installation staff and a range of useful equipment. The Gallery also provides a printed invitation to promote exhibitions, written didactics and labels relevant to exhibition artwork, and an exhibition opening event, including catering.

Artists wishing to seek additional support for their exhibition should contact Arts Queensland (<http://www.arts.qld.gov.au/>) or Logan City Council (<http://www.logan.qld.gov.au/community-support/grants/regional-arts-development-fund>) for specific information on the grants available and eligibility requirements.

Installation

The installation and demounting of your work will be carried out by the gallery installation staff. Exhibitions change approximately every six weeks. Installation generally occurs on the Tuesday of installation week, and the official opening is usually held on Friday evenings. This is subject to change at the Gallery's discretion.

Equipment

Logan Art Gallery makes equipment available to artists for their exhibition. This is subject to availability, and the gallery must be notified well in advance. The gallery's equipment includes plinths and display cases, moveable walls, DVD players, data projectors and televisions.

Gallery specifications

Gallery One

Ceiling height: Low point 2.36 m, High point 5.9 m
Running meters: 19.45 m
Power points: 2
Walls: Brick with hanging track, and one plaster wall

Gallery Two

Ceiling height: Low point 3.35 m, High point 5.9 m
Running meters: 32.68 m
Power Points: 3
Walls: Plaster and brick with hanging track

Gallery Three

Ceiling height: Low point 3.35 m, High point 5.9 m
Running meters: 29.96 m
Power points: 4
Walls: Plaster and brick with hanging track

Young People's Gallery

Ceiling height: Low point 3.35 m, High point 5.9 m
Running meters: 8.11 m
Power points: 1
Walls: Plaster with hanging track

Gallery Foyer

Ceiling height: Low point 2.36 m, High point 5.9 m
Running meters: 22.46 m
Power points: 3
Walls: Plaster with hanging track

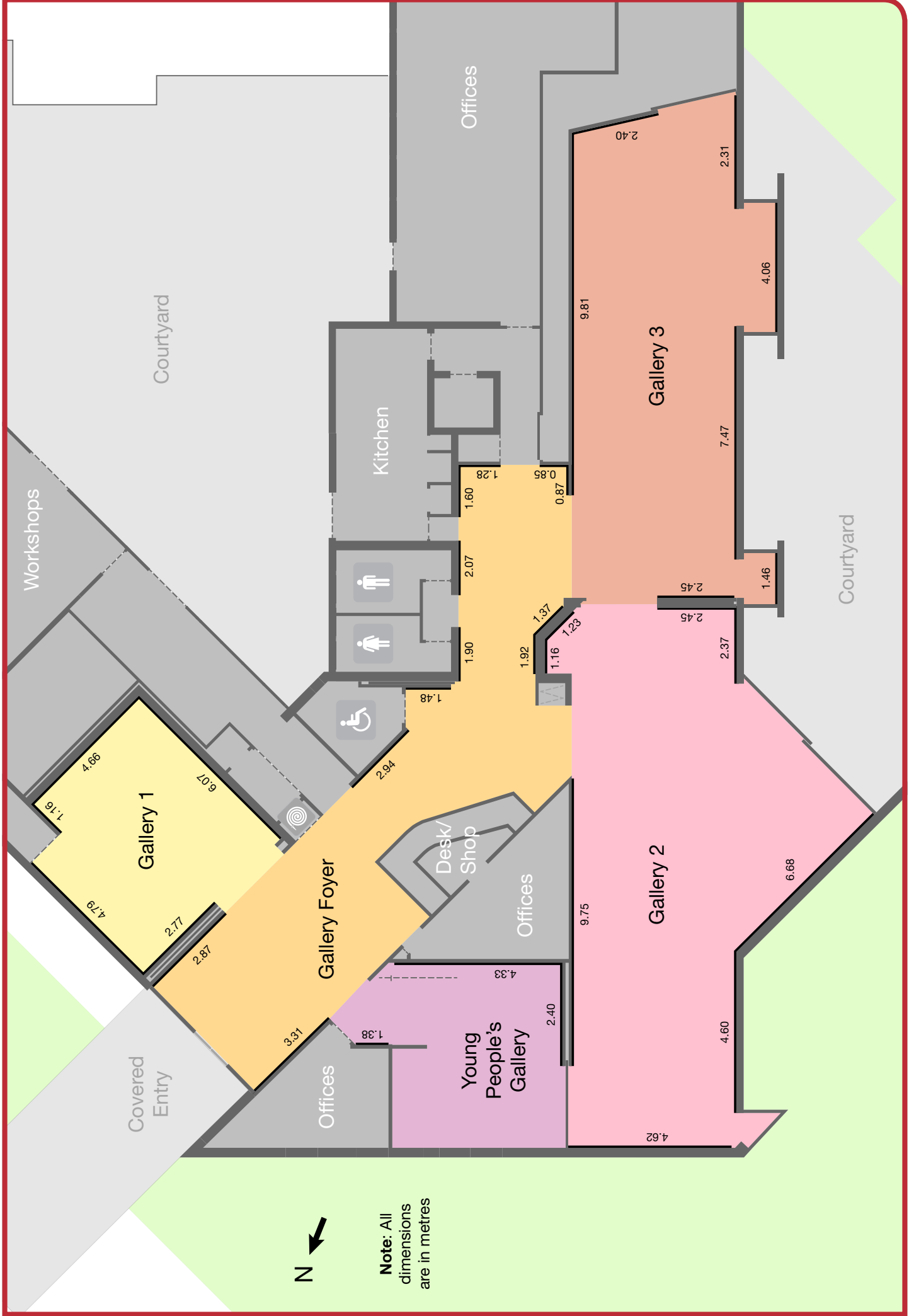

SOLO EXHIBITION PROPOSAL APPLICATION FORM

www.logan.qld.gov.au/artgallery

Page 1 of 5

Personal details

Name

Address

Telephone

Mobile phone

Email

ABN

Are you registered for GST?

☐

Yes

☐

No

(OR please indicate if you need to fill out an
ATO Statement by Supplier Form)

Exhibition summary

Title of
exhibition

Medium/s

Which gallery space are
you interested in?

☐

Gallery One

☐

Gallery Two

☐

Gallery Three

☐

Young People's Gallery

☐

Foyer Gallery

Will your work be for sale?

☐

Yes

☐

No

(Please note that the Gallery receives
a 20% commission on all sales).

Date exhibition is available

Equipment required

Public programs:

Are you interested in conducting any public programs?
i.e. floor talk or workshops.

☐

Yes

☐

No

Project summary:

(Briefly describe your project in 80 words)



What themes are explored with your artwork? What is the exhibition about? Why are you proposing to create it?

Please describe in **200 words or less** what your exhibition will contain, and any thoughts about how it might be displayed within the gallery space. For example: *Four photographs of people on bicycles, each 100 x 100 cm installed on rear wall, two sculptures of BMX bikes placed on plinths in centre of room. A video work about BMX racing projected on to left-hand wall.*

This image shows a single sheet of white paper with horizontal blue ruling lines. The lines are evenly spaced and run across the width of the page. There is no handwriting or other markings on the paper.

SOLO EXHIBITION PROPOSAL

SUPPORT MATERIAL

www.logan.qld.gov.au/artgallery

Page 3 of 5

Please include five to ten images or no more than six minutes of video. Please include examples of previous artwork **and** new work that you have made specifically for your proposed exhibition.

- For video works, please provide your work on a playable DVD in one of the following formats: QuickTime, Windows Media, or MPEG4. **ALL** moving images must be submitted on disk. Please indicate this below.
- For still images, please submit them on disk and ensure they are print quality ie. over 1Mb and at least 300dpi. If you are unable to submit digital images, we will accept clearly printed, labelled, in-focus images.
- If you are emailing your application, please attach low resolution images to the email and post a DVD of any moving images. Please indicate this below.

Image details

Image no. or filename	Title of work	Date	Medium	Dimensions	Photographer	New work or previous work?
						New <input type="checkbox"/> Previous <input type="checkbox"/>
						New <input type="checkbox"/> Previous <input type="checkbox"/>
						New <input type="checkbox"/> Previous <input type="checkbox"/>
						New <input type="checkbox"/> Previous <input type="checkbox"/>
						New <input type="checkbox"/> Previous <input type="checkbox"/>
						New <input type="checkbox"/> Previous <input type="checkbox"/>
						New <input type="checkbox"/> Previous <input type="checkbox"/>
						New <input type="checkbox"/> Previous <input type="checkbox"/>
						New <input type="checkbox"/> Previous <input type="checkbox"/>
						New <input type="checkbox"/> Previous <input type="checkbox"/>



Page 4 of 5

In one page or less, please list your training and achievements related to your chosen field of artistic endeavour.

SOLO EXHIBITION PROPOSAL APPLICANT DECLARATION

www.logan.qld.gov.au/artgallery

Page 5 of 5

This form is an expression of interest only. Logan City Council reserves the right to review works, exhibitions, proposals and submissions in respect to the Logan Art Gallery exhibition program.

I, , have read and completed all the information in this application.

Signature

Date

Further information

If you have any questions or need assistance in completing your application, please contact the Exhibitions Officer:

Exhibitions Officer

Phone: 07 3412 5519

Email: artgallery@logan.qld.gov.au

Returning forms

Please post your Exhibition Proposal to:

Logan Art Gallery
PO Box 3226
Logan City DC QLD 4114

OR

Email your application to:

artgallery@logan.qld.gov.au. If emailing your application please send this PDF and your images. The total of your images and documents must be less than 10 Mb.

Application checklist

☐

Completed and signed exhibition proposal

☐

5-10 high resolution images on disk **OR** printed **OR** less than 6 minutes of video on DVD **OR**
5-10 low resolution images included in your emailed application

**Thank you for submitting your exhibition
proposal to Logan Art Gallery.**

Your application will not be returned.

Please make a copy of it for your records.

Logan City Council is collecting your personal information in order to be able to assess your proposal and contact you in regards to your exhibition application. This information is available to council staff only. Subject to these disclosures your information will not be given to any other person or agency unless you have given us permission to do so, or we are required by law.

(DM#7827028)

logan art
gallery

CITY OF OPPORTUNITIES
FOR FAMILIES, LIFESTYLE AND BUSINESS

