

SPARE PARTS BILL OF MATERIAL

Reference date 24/11/2017

IKEA FULLSTANDING

E-Number / 12NC	Commercial Description	Application	Electrical scheme No.	ECN
856730600120	FULLSTÄNDIG 70389337	Ricambi	SEL0135484	313846

ID	ID 2	Code	Description Descrizione	UM	Qty	Predecessor Code	Reference date
56	0010	TBV0135106	BOTTOM CHIMNEY SECTION TUB INF VER. WHITE BAULETTO	EA	1,000		
57	0011	TBV0135103	UPPER CHIMNEY SECTION TUB SUP VER. WHITE BAULETTO	EA	1,000		
97	0015	STA0129585A	STAFFA CAMINO STAFFA TUBO SUPERIORE MODERN	EA	1,000		
8	0711	SUP0021041E	MOTOR SUPPORT SUP MOTORE S FLASH	EA	1,000		
173	3202	VER0129418	SIDE MOULDES MOSTR.TUBO RACC.FILTRANTE 204,4MM CROMO	EA	2,000		
236	3340	MNP0128485A	CUFF MANOPOLA COMANDI TRADITIONAL	EA	1,000		
7	4010	MOT0116565	MOTOR MOT M02321 PUNT. 4V	EA	1,000		
84	4110	TRF0096050B	TRASFORMER DRIV.LED 700mA 10W 110-240V 50-60Hz CCC	EA	1,000		
19	4200	CND0025409	CAPACITOR COND. 3,15uF P2 F6,3	EA	1,000		
20	4210	BCO0109676	CONNECTOR CONNECT. 2 WAY IEC320 WHIT SCR.	EA	1,000		
51	4840	CAV0107881	WIRING CAVO.AL.1,5 SCHUKO BIP + IEC 2X0,75	EA	1,000		
234	6200	INT0130562	ROTATING SWITCH INTER.ROT. 4 POSIT.	EA	1,000		
271	6200	AGC0135189	ELECTRONIC PANEL AGC 1ROT 2TOG BAULETTO	EA	1,000		

SPARE PARTS BILL OF MATERIAL

Reference date 24/11/2017

IKEA FULLSTANDING

E-Number / 12NC	Commercial Description	Application	Electrical scheme No.	ECN
856730600120	FULLSTÄNDIG 70389337	Ricambi	SEL0135484	313846

ID	ID 2	Code	Description Descrizione	UM	Qty	Predecessor Code	Reference date
31	6510	LMP0128095	LED MODULE LAMP LED CAB 700mA 7W 3000K SL17 629.7	EA	1,000		
6	7271	GN01WB	FAN WHEEL COUNTERCLOCKWISE ROTATION GIRAN.C.E.MOT.S.59 PALE D.6.	EA	1,000		
87	7413	RAC0130002A	CONNECTION PIECE PROL. RACC. FILT. MODERN	EA	2,000		
137	7415	CNV0108211C	LEFT HALF CONVEYOR COCLEA SX ETB160	EA	1,000		
136	7416	CNV0108212C	RIGHT HALF CONVEYOR COCLEA DX ETB160	EA	1,000		
129	7430	RAC0128735A	T CONNECTION RACC.FILTR.150 USCITA LIBERA TRADITIONAL	EA	2,000		
23	7620	GRI0132709A	GRIGLIA FILTRO GFM 290X275X9 IKEA	EA	2,000		
120	7650	CFC0038668	KIT CARBON FILTER MOD. 57 KIT FC MOD.57 SING.2PZ	EA	1,000		
1	7811	RAC0138595A	FLANGE + VALVE A.RACCORDO ETB-160 D.150 + VNRF	EA	1,000		
2	7812	3010EH	MULTI-CONNECTION FLANGE 150/125-120 R.U.A.MULT.XD.150/125-120 PPV2	EA	1,000		
517	9101	BOC0129724A	BUSH BOCCOLA INT.BASCULANTE TRADITIONAL	EA	2,000		
519	9930	DOC0135076	DOCUMENTATION DOC.BAULETTO IKEA 80CM	EA	1,000		
588		INT0129501	SWITCH INTERRUTTORE BASCULANTE IKEA 2016	EA	2,000		

SPARE PARTS BILL OF MATERIAL

Reference date 24/11/2017

IKEA FULLSTANDING

E-Number / 12NC	Commercial Description	Application	Electrical scheme No.	ECN
856730600120	FULLSTÄNDIG 70389337	Ricambi	SEL0135484	313846

ID	ID 2	Code	Description Descrizione	UM	Qty	Predecessor Code	Reference date
448		ALB0130379	SHAFT GEARS ALBERO INTERR. L=11,1	EA	1,000		

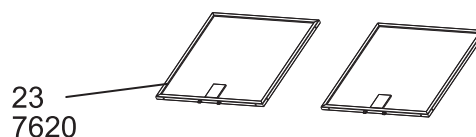
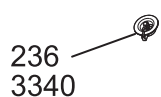
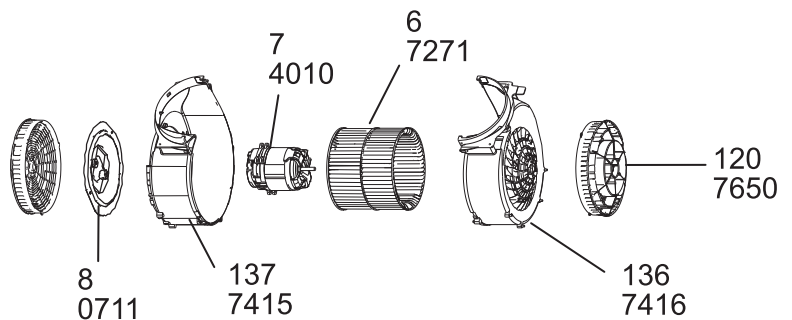
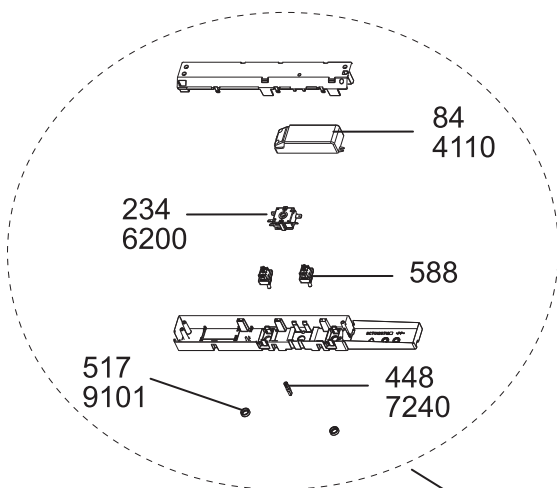
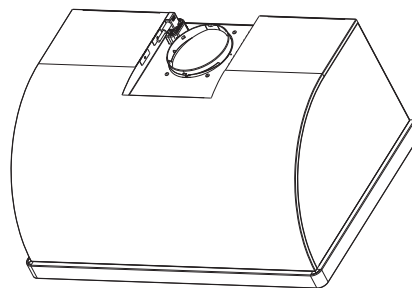
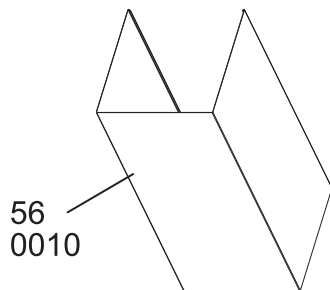
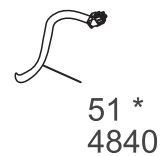
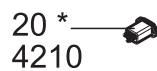
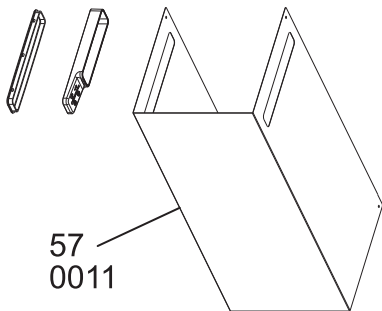
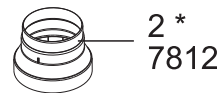
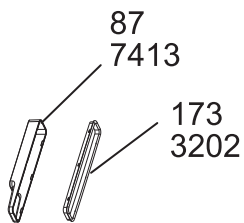
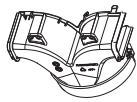
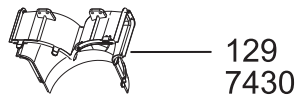

* Optional

S10178

see also bill of material