

MINIMUM BID SPECIFICATIONS BID FORM

Construction of a 30X60X20 All-Steel Building with 16X25 Lean-To

City of Glasgow – Department of Public Works

We, the undersigned, propose to furnish the item listed below and guarantee that if we are awarded the bid, we will furnish the goods in accordance with the attached specification. THIS FORM MAY BE COPIED

TOTAL BID PRICE: _____

ESTIMATED CONSTRUCTION TIME: _____
(Length of Construction Time is Important Consideration)

EXCEPTIONS: _____

_____.

BID PRICE IS GUARANTEED FOR 90 (NINETY) DAYS AFTER BID OPENING BY CITY OF GLASGOW – DEPARTMENT OF PUBLIC WORKS.

Authorized Signature

Name of Firm

Printed Name of Signee

Address

Date

City, State, Zip Code

Telephone Number

Fax Number

BIDS:

All Bids shall be submitted on forms supplied by the City of Glasgow – Department of Public Works.

Bid documents shall be enclosed in an envelope clearly labeled with: Bid Documents, "Construction of 30X60X20 All-Steel Building with 16X25 Lean-To", Your Name, September 21, 2012 4 p.m." in order to guard against premature opening of bids. Each bid shall be addressed to : **Glasgow City Hall, Office of the Mayor, P.O. Box 278, Glasgow, Kentucky 42142-0278.** It is the sole responsibility of the bidder to see that his bid is received on time.

BIDDERS QUALIFICATIONS:

The City of Glasgow – Department of Public Works shall have the right to take such steps as it deems necessary to determine the ability of the bidder, to perform his obligations under the Contract and the bidder shall furnish the City of Glasgow all such information and data for this purpose, as the City of Glasgow may request it. The right is reserved to reject any bid where an investigation of the available evidence or information does not satisfy the City of Glasgow, whereas the bidder is qualified to carry out properly the terms of the contract.

AWARD OF CONTRACT: REJECTION OF BIDS:

The Contract will be awarded to the responsible bidder submitting the lowest evaluated bid complying with the specifications. The award of the Contract will be based upon consideration of not only cost, but also experience with similar projects, staffing, equipment, present workload and demonstrated ability to meet schedules. The City of Glasgow will give weight to each of the above selected criterion based upon the relative importance of each to this project. The City of Glasgow, however, reserves the right to reject any and all bids and to waive any formality in bids received whenever such rejection or waiver is in the City of Glasgow's interest. The Bidder to whom the award is made will be notified at the earliest possible date.

MINIMUM BID SPECIFICATIONS:**Construction of a 30X60X20 All-Steel Building with 16X25 Lean-To**

It is the intent of these specifications to describe **Construction of a 30X60X20 All-Steel Building with 16X25 Lean-To.** These specifications describe and state minimum requirements. Bids submitted not meeting these minimum requirements will be subject to rejection.

The following are intended as guidelines, all equivalent or comparable units will be considered.

All bidders must fill in all blanks **Yes** if meeting or exceeding specification and **No** if exceptions are taken. Bidder must attach a copy of factory warranty.

SPECIFICATIONS:	YES	NO	OFFERED
• Construction of a 30x60x20 All-Steel Building With a 16x25 Lean-To.	_____	_____	_____
○ 3" Insulation	_____	_____	_____
○ Gutters & Downspouts	_____	_____	_____
○ 26 Gauge #1 Painted Metal	_____	_____	_____
• 10' Tall Inside Liner Panels	_____	_____	_____
• One Entrance Door	_____	_____	_____
○ 2 - 14'X14X Industrial Grade Insulated Overhead Doors	_____	_____	_____
○ Electric Openers	_____	_____	_____
• Concrete Footer & Piers	_____	_____	_____
• Concrete Floor	_____	_____	_____
○ Two Mud Pit Drains	_____	_____	_____
○ 6" Thick 4000 psi Cement	_____	_____	_____
○ Rebar on 2' Squares	_____	_____	_____
• 1,000 Gallon Oil and Water Separator	_____	_____	_____
• Six (each) 400 Watt Lights	_____	_____	_____
○ Fixtures	_____	_____	_____
○ Installation	_____	_____	_____
• 200 Amp Service	_____	_____	_____
○ Hardware	_____	_____	_____
○ Installation	_____	_____	_____
• Two (each) 150,000 BTU Gas Heaters	_____	_____	_____
○ Hardware	_____	_____	_____
○ Installation	_____	_____	_____
• Building Erection	_____	_____	_____

See Attached Drawing

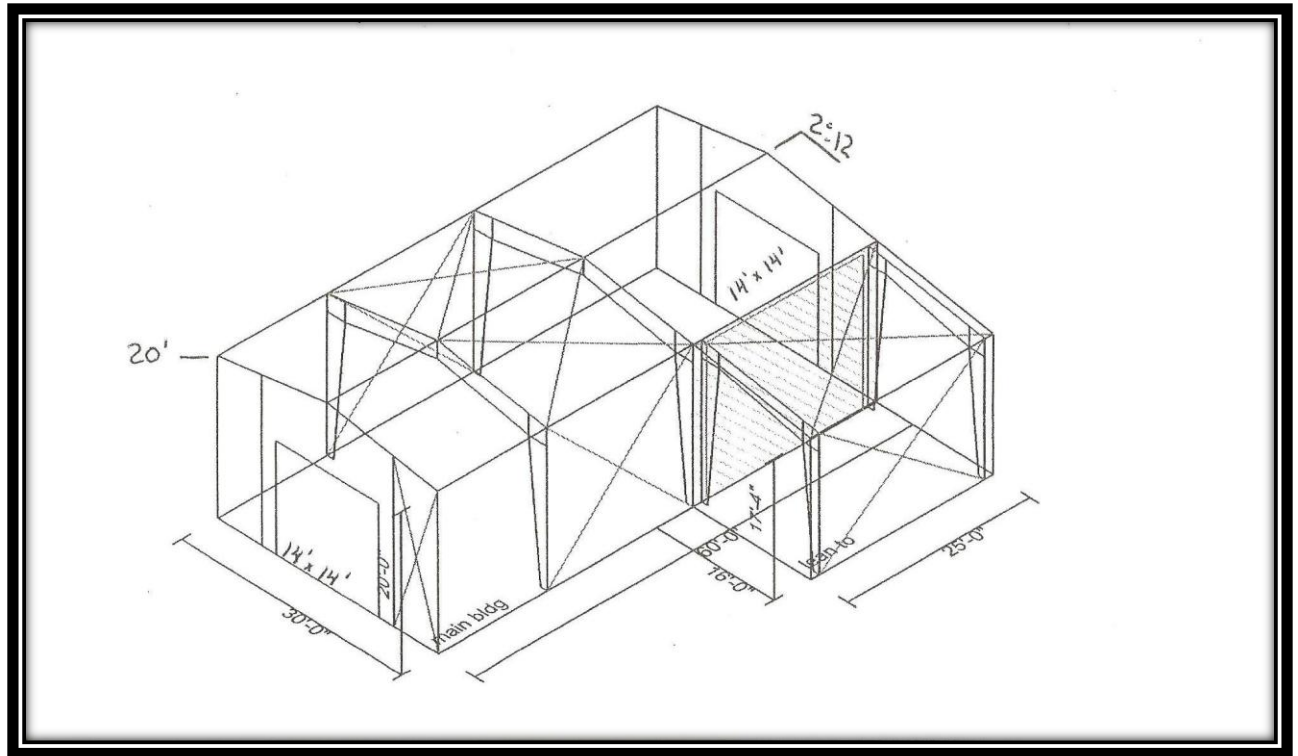

RESPONSIBILITY OF BIDDER FORM

This form must be completed in full and submitted with bid. Misrepresentation or failure to complete will automatically disqualify bid. All information is confidential and exempt from the Open records Law, pursuant to KRS 45A.395.

NAME _____ PHONE (_____) _____

ADDRESS			
Street or P.O. Box	City	State	Zip Code

- 1) Type of services/supplies provided in normal course of business: _____
- 2) Length of time in business: _____
- 3) Experience in providing bid required services/supplies: _____
- 4) Currently a party / defendant in lawsuit(s)? (☐) Yes (☐) No If yes, explain _____

- 5) State past history as party / defendant in lawsuit(s) _____
- 6) Name of contract / product liability insurance Carrier: _____
- 7) Limits: \$ _____
- 8) If construction bid how many other projects currently ongoing? _____
- 9) How many bids currently submitted elsewhere? _____
- 10) Have books been audited by CPA? (☐) Yes (☐) No Date of last audit? _____
- 11) City of Glasgow Occupational License No.: _____
- 12) List of reference (public or private) and contact person for whom similar services / supplies provided: _____

[illegible]

Name of Firm	Address	Contact Person
--------------	---------	----------------

Name of Firm	Address	Contact Person
--------------	---------	----------------

***Note: If more space is needed, please attach separate sheet(s).**

I do solemnly swear that to the best of my knowledge and belief the above is true and accurate statement of facts.

Signed _____ Date _____

State of _____ County of _____

Sworn to and subscribed before me, a Notary Public, this _____ day of 2012. My commission
expiration date _____ Notary Public _____.