



Skill Building Kansas Sampler

We hope you enjoyed making the first block in the Skill Building Kansas Sampler, the Signature Block. The next block is comprised of flying geese units. While designing this quilt, I tried to use Kansas themed blocks or blocks that related to the state of Kansas and some background information that you might find interesting.

This block represents the geese that fly the Central Flyway from central Canada through Kansas to the Gulf of Mexico. There are nine species of geese that fly through Kansas on the Flyway.

If you have any problems with any of the blocks in this program, please feel free to call the shop at 913-682-8000 or stop by and we will be happy to help you.

Thank you again for joining us and we look forward to serving you and your creativity. Happy Quilting!

First City Quilts

Skill Building Kansas Sampler

Skill Building Kansas Sampler

Block Two – Geese in the Round Block

Quilt designed and written by Maria McKenzie



First City Quilts LLC
200 South 5th Street
Leavenworth, KS 66048
913-682-8000
www.firstcityquilts.com

Block Two – Geese in the Round Block

Cutting Instructions:

Cream

Cut (16) - $3\frac{1}{2}$ " x $3\frac{1}{2}$ " squares

Red

Cut (2) - $3\frac{1}{2}$ " x $6\frac{1}{2}$ " rectangles

Rust

Cut (2) - $3\frac{1}{2}$ " x $6\frac{1}{2}$ " rectangles

Black #1

Cut (2) - $3\frac{1}{2}$ " x $6\frac{1}{2}$ " rectangles

Black #2

Cut (2) - $3\frac{1}{2}$ " x $6\frac{1}{2}$ " rectangles

Sewing Instructions:

Use $\frac{1}{4}$ " seam allowance unless otherwise noted.

Draw a diagonal line on the wrong side of the cream $2\frac{1}{2}$ " squares.



Align a cream square to the left side of a rectangle, right sides together as shown. Sew along the diagonal line. Trim lower left triangle off $\frac{1}{4}$ " past seam. Press toward the cream. Make two of each color.

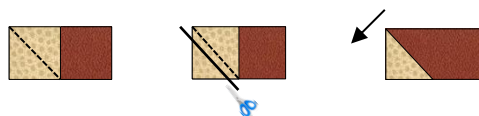

Align a cream square to the right side of a rectangle, right sides together as shown. Sew along the diagonal line. Trim lower right triangle off $\frac{1}{4}$ " past seam. Press toward the cream. Make two of each color.

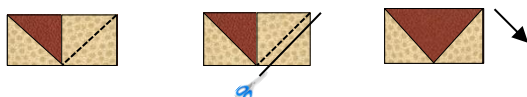

Sew a rust and black flying geese unit together as shown. Sew with the rust flying geese on top to ensure perfect point. Press seam toward the black.

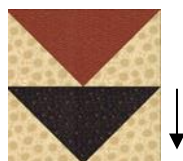

Make two. Square to $6\frac{1}{2}$ " x $6\frac{1}{2}$ ".



Sew a red and black flying geese unit together as shown. Sew with the black flying geese on top to ensure perfect point. Press seam toward the red. Make two. Square to $6\frac{1}{2}$ " x $6\frac{1}{2}$ ".



Sew a rust/black unit to a red/black unit as shown. Press seam toward the red unit. Make two.



Sew units together as shown. Press seam open. Square block to $12\frac{1}{2}$ " x $12\frac{1}{2}$ ".

Next Month's Block – Kansas Dugout Block

