

Pre-Authorized Warranty Repair Guideline RWRG0051

RWRG0051 - Splitter Complaint - Fault Code 42

Symptom(s)

A Fault Code 42 with:

- A complaint of transmission only shifting in odd or even gears when splits should occur, or
- Slow splits

Cause

Splitter cylinder walls may become dry or have contamination build up in the cylinder which may cause the piston to move slowly or not at all.

Background

In the early stages there will be evidence of missed splitter shifts causing the driver to have only odd or even gears in the range that can be split. If the condition exists long enough there may be signs of damage to o-rings or splitter solenoid valve. Any evidence of corrosion where the cylinder has a build-up of rust, water and dirt will be cause for claim denial.

Repair Guideline

Perform the trouble shooting steps per the appropriate guide and check for correct air pressures.

STEP A:

1. Key off
2. Install a 0-100 PSI air pressure gauge in the regulated test port of the air filter/regulator.
3. Start engine and allow air pressure to build to governor cut-off.
4. Monitor vehicle air pressure gauge on the dash and if vehicle maintains air pressure go to Step B.

STEP B:

1. If air pressure is 55 to 65 PSI go to Step C.

STEP C:

1. Key off.
2. Install (2) 0-100 PSI air pressure gauges in the splitter cover diagnostic ports.
3. Start vehicle and allow air pressure to build to governor cut-off.

4. Release clutch (AutoShift only) to register input shaft speed in the transmission.
5. Turn off engine but leave the key in the ON position.
6. With Shift Control, select reverse (R1 in gear display for 13/18 speed), and then select neutral. If LOW splitter gauge = 55 to 65 PSI and if HIGH splitter gauge = 0 PSI go to step D:

Note: Five minutes is allowed for checking the air pressure after shifting the transmission to neutral.

STEP D:

1. Key on
2. With Shift Control, select reverse gear (R2 in the gear display for 13/18 speed) by pressing the upshift button/arrow, and then select neutral. If HIGH splitter gauge = 55 to 65 PSI and if LOW splitter gauge = 0 PSI then repair the mechanical splitter system by removing the splitter cylinder cover and inspect the splitter cylinder.

Note: Five minutes is allowed for checking the air pressure after shifting the transmission to neutral.

After T/S of fault code if the technician determines the need to disassemble, try shop air to the cylinder housing port manually before disassembly, listening to determine if the piston moves in and out. Once the need to visually inspect the splitter cylinder is determined the tech may replace the o-rings and re-lube the cylinder walls with the silicone lubricant provided in the kit.

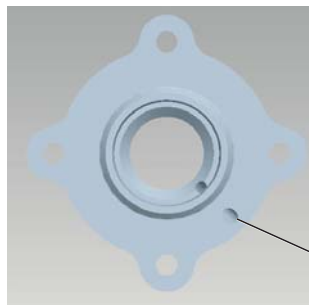

Feed air manually to this port, listen for piston to move in and out.

Recommended Software Update

Update software to the latest available version in ServiceRanger for all in-warranty transmissions.

Note: Please confirm the ServiceRanger program has the latest version and database. Please follow <http://www.roadranger.com/rr/CustomerSupport/Support/ServiceRanger/index.htm> to update the ServiceRanger program. Confirm the use of an approved communication adapter and ensure that all satellite systems are disabled.

Warranty Parts

- K-2803

Warranty Labor

- When diagnosing, the splitter complaint or software update will pay OEM SRT diagnostic time.
- When repair requires the replacement of the K-3510 the repair pays OEM SRT for splitter overhaul.

Warranty Coding

ATA Code: NA

Failed Part #: K-2803

Complaint Code: Splitter Shift - Slow (55)

Failure Code: Splitter Shifts (AG)

Responsibility Code: Vendor part (418)

Warranty Claim Filing

Reference warranty coverage. File pre-authorized warranty claim through appropriate OEM or through Direct Pay. Reference guideline number RWRG0051 in warranty claim text.

Note: Repairs that exceed parts and labor parameters cannot be pre-authorized.

Filing through Direct Pay

Click here for Direct Pay submission guidelines and claim forms:



**Submission Guidelines
and Claim Forms**

Parts Disposition

Parts can be scrapped.

Warranty Disclaimer

If the failure is not the result of an accident, damage, negligence, abuse or misuse, improper installation or maintenance or any other conditions described in the Limits and Exclusions section of Warranty Manual TCWY0600, then Roadranger will treat the condition as covered under its warranty. However, this conclusion does not necessarily mean that a defect in fact exists. In all cases, Roadranger shall make the final determination and interpretation as to the warrantability of the Product.