



# PALM BEACH STATE COLLEGE

Guidebook – revised fall 2022

[Click Here for Music Career Pathway Link](#)

## TABLE OF CONTENTS

<u>Advising/Where to Start</u> .....	2
<u>Applied Lessons</u> .....	6
<u>Auditions</u> .....	7
<u>Campus Map</u> .....	18
<u>Full-Time Music Faculty/Contact Information</u> .....	2
<u>Grievance Procedure</u> .....	8
<u>Humanities Building Room Maps</u> .....	17
<u>Juries</u> .....	8
<u>Keys to Success</u> .....	16
<u>Lockers</u> .....	10
<u>Music Career Pathway – Course of Study</u> .....	4
<u>Music Career Pathway – Web Link</u> .....	3
<u>Music Ensembles</u> .....	10
<u>Music Scholarships</u> .....	12
<u>Non-Music Pathway Classes</u> .....	5
<u>Performances</u> .....	14
<u>Practice Rooms</u> .....	14
<u>Recital Seminar</u> .....	14
<u>Sophomore Recital</u> .....	15
<u>Who Can Take Music Classes?</u> .....	2

## WHO CAN TAKE MUSIC CLASSES?

The Music Department offers classes to meet the needs of three (3) kinds of students:

- **Music Pathway students transferring to university** – for those who wish to transfer to a four-year university and complete a degree in Music Composition, Education, Performance, Technology, Theory or Therapy.
- **Non-Music Pathway students transferring to university** – for those who are attending PBSC but are pursuing a Pathway outside of Music and wish to take music classes as a secondary area of study, to fulfill a general education requirement, or for personal enrichment.
- **Non-degree seeking students** – for those who are not pursuing a degree who wish to develop their musical skills and knowledge for career advancement, a secondary career area, or for personal enrichment.

***No matter what your musical goals, the Palm Beach State Music Department can provide you with the education, skill, training, and musical experiences to start you on the way to achieving your goal.***

## ADVISING/WHERE TO START

1. Apply to PBSC via this link: <https://www.palmbeachstate.edu/admissions/admissions-applications.aspx>.
2. Once accepted by Palm Beach State, arrange a meeting with a full-time Music Department faculty member to discuss your schedule (see below).
3. Make an appointment with Don Lawrence, the Humanities Academic Advisor (see below).
4. Apply for Music and other scholarships through the Palm Beach State College Foundation at <https://www.palmbeachstate.edu/foundation/student-scholarships/foundation-faq.aspx>. This MUST be done before the deadline in AUGUST in order to be eligible for any scholarship in the upcoming school year. Students who do not apply will NOT be eligible for scholarships.
5. Register for classes EARLY! This will enable you to register for the classes that you want at the times that are the most convenient for you.
6. Make note of the Music Department orientation and audition dates\* for applied lessons, scholarships, and ensembles.

\*Orientation and auditions for applied lessons take place before classes begin. Scholarship and ensemble auditions take place after the beginning of the semester.

## FULL-TIME MUSIC FACULTY/CONTACT INFORMATION

Name	Area	Office	Phone	Email
Gibble, David	Music Department Chair; Instrumental Music & Jazz	HU 118	868-3266	<a href="mailto:gibbled@palmbeachstate.edu">gibbled@palmbeachstate.edu</a>
Webber, Allen	Music Theory; Choral Music	HU 116	868-3267	<a href="mailto:webbera@palmbeachstate.edu">webbera@palmbeachstate.edu</a>
<b>Other Important Contact Information</b>				
DeJesus, Sylvia (admin assistant)	Humanities Division Office	HU 126	868-3270	<a href="mailto:dejesuss@palmbeachstate.edu">dejesuss@palmbeachstate.edu</a>

## MUSIC CAREER PATHWAY – WEB LINK

To access the Music Pathway or more Music Department information scroll down the page on the following link and click on the down arrow on the right-hand side:

<https://www.palmbeachstate.edu/career-pathways/pathway-art/default.aspx#aa>



PantherWeb | Blackboard | Directory |  
Faculty/Staff



### Associate in Arts (A.A.) Degree

The Associate in Arts transfer degree equals the first two years of a bachelor's degree. By earning your A.A. degree at PBSC, you are guaranteed admission to one of Florida's public universities to complete your bachelor's degree. You also may transfer to certain private institutions or PBSC bachelor's programs. Our A.A. degree advising tracks will help guide you in selecting general education and elective courses that fit your desired upper-division major and the requirements of your chosen transfer school. Always work with your PBSC academic advisor in making your final choices.

Architecture	↓
Art	↓
Art Teacher Education	↓
Communication	↓
Dramatic Arts/Theatre	↓
English Language & Literature	↓
Graphic Design	↓
Journalism	↓
Motion Picture	↓
★ Music	↓
Philosophy	↓

Click here



[Click Here for Music Career Pathway Link](#)

## MUSIC CAREER PATHWAY – COURSE OF STUDY\*

SEMESTER	COURSE ID	COURSE NAME	CREDITS
<b>FALL 1</b>	MUN 1xxx	Major Ensemble*	1.0
	MUS 0010L	Recital Seminar	0.0
	MUT 1111	Music Theory 1** (AA)	3.0
	MUT 1241L	Ear Training 1 (AA)	1.0
	MVK 1111A	Class Piano 1	1.0
	MVx 131x	Applied Music Lessons Freshman	1.0
	ENC 1101	College Composition 1 (AA)	3.0
	SLS 1501	Introduction to the College Experience (AA)	3.0
<b>SPRING 2</b>	MUN 1xxx	Major Ensemble*	1.0
	MUS 0010L	Recital Seminar	0.0
	MUT 1112	Music Theory 2 (AA)	3.0
	MUT 1242L	Ear Training 2 (AA)	1.0
	MVK 1111B	Class Piano 2	1.0
	MVx 131x	Applied Music Lessons Freshman	1.0
	ENC 1102	College Composition 2 (AA)	3.0
	MGF 1106	Liberal Arts Mathematics (AA)	3.0
<b>SUMMER 3</b>	EVR 1001	Introduction to Environmental Science (AA)	3.0
	MGF 1107	Finite Mathematics (AA)	3.0
	<b>OR</b> STA 2023	Statistics (AA)	3.0
	SPC 1017	Fundamentals of Speech Communication	3.0
<b>FALL 4</b>	MUN 1xxx	Major Ensemble*	1.0
	MUS 0010L	Recital Seminar	0.0
	MUT 2116	Music Theory 3 (AA)	3.0
	MUT 2246L	Ear Training 3 (AA)	1.0
	MVK 2121L	Class Piano 3	1.0
	MVx 232x	Applied Music Lessons Sophomore	1.0
	BSC 1005	Concepts in Biology	3.0
	LIT 1000	Introduction to Literature*** (AA)	3.0
<b>SPRING 5</b>	MUN 1xxx	Major Ensemble*	1.0
	MUS 0010L	Recital Seminar	0.0
	MUT 2117	Music Theory 4 (AA)	3.0
	MUT 2247L	Ear Training 4 (AA)	1.0
	MVx 232x	Applied Music Lessons Sophomore	1.0
	AMH 2020	United States History from 1865 to Present (AA)	3.0
	<b>OR</b> POS 1041	Introduction to American Government (AA)	3.0
	PSY 2012	Introduction to Psychology (AA)	3.0

\* The *Major Ensemble* is dependent on area of Applied Music lesson (see p. 7).

\*\* *Music Theory 1* counts as a “tier 2” Humanities General Education class.

\*\*\* *Introduction to Literature* counts as a “tier 1” Humanities General Education class.

[Click Here for Music Career Pathway Link](#)

## NON-MUSIC PATHWAY CLASSES

ALL Palm Beach State music classes are open to ALL Palm Beach State students. This includes those who are following a non-Music Pathway, working on an A.S. or A.A.S degree, or are part-time and non-degree seeking.

### GENERAL EDUCATION OFFERINGS (3 credits each)

- Fundamentals of Music (MUT 1001 – tier 2): an introduction to music theory and music notation.
- Music Theory 1 (MUT 1111 – tier 2): an introduction to music theory and music notation.
- History and Appreciation of Jazz (MUH 2018 – tier 2): a study of jazz music and performers in 20<sup>th</sup> century America.
- Music Appreciation (MUL 1010 – tier 1): a study of Western art music from the Middle Ages to the present.

### ENSEMBLES\* (1 credit each)

- Concert Band (MUN 1120) – audition required
- Concert Chorus (MUN 1310) – no audition required
- Jazz Combo (MUN 1710 C) – audition required
- Tuesday Nite Big Band (MUN 1710 D) – audition required
- Jazz Guitar Ensemble (MUN 1710 E) – audition required

\*See Music Ensembles pp. 6-7 for more information; contact David Gibble at [gibbled@palmbeachstate.edu](mailto:gibbled@palmbeachstate.edu) for audition information

### APPLIED (PRIVATE) LESSONS\*\* (1 credit each)

- Voice (MVV 1311)
- Classical Guitar (MVS 1316)
- Classical Piano (MVK 1311)
- Band instruments
  - Flute (MVW 1311), Oboe (MVW 1312), Clarinet (MVW 1313), Saxophone (MVW 1315), Trumpet (MVB 1311), Trombone (MVB 1313), Percussion (MVP 1311)
  - Available as needed: Bassoon, French Horn, Euphonium, Tuba and Bass Guitar
- Jazz Guitar (MVJ 1313)
- Jazz Piano (MVJ 1314)

\*\* Students in Applied Lessons will also need to take a Music Ensemble and Recital Seminar (MUS 0010); see Applied Lessons on pp. for more information

### BEGINNING CLASS INSTRUCTION\*\*\* (1 credit each)

- Class Piano (MVK 1111)
- Class Guitar (MVS 1116)
- Class Voice (MVV 1111)

\*\*\*No auditions or pre-requisites required

(“Applied Lessons” on next page.)

## APPLIED LESSONS

Applied lessons are one-on-one private lessons that meet once a week for fifty (50) minutes on your principal instrument/voice over the course of a semester and are worth one credit.

### ELIGIBLE STUDENTS

#### Music Pathway students – principal instrument

- Music Pathway students should take applied lessons on their principal instrument every fall & spring semester while a student at Palm Beach State. Additional supplemental applied lessons are available during the summer A & B sessions.

#### Music Pathway students – principal instrument

- Music Pathway students are permitted to take applied lessons on a secondary instrument (or voice) if they meet each of the following criteria:
  - Have successfully completed at least one semester of applied lessons on their major instrument
  - Have the approval of their principal applied lesson teacher to study a second instrument
  - Pass a qualifying audition on the secondary instrument, usually held before the first day of classes
  - There is space available in the secondary applied lesson teacher's schedule
  - Maintain a "B" average in the major applied area, and an overall GPA of 2.5 (C+).

#### Non-Music Pathway students

- Non-Music Pathway students are eligible for applied lessons if they pass a qualifying audition held before classes begin every semester and if there is space available.

### REQUIREMENTS

ALL students taking applied lessons, regardless of primary Pathway, are required to:

1. Pass a qualifying [Audition](#) (see p. 12)
2. Register for and participate in at least one Palm Beach State-Lake Worth [Musical Ensemble](#) (see p. 10). Ensemble participation is required each semester that the student takes applied lessons.
  - **Wind Instrumentalists and Percussionists** – Concert Band.
  - **Vocalists** – Concert Chorus.
  - **Classical Guitar** – Classical Guitar Ensemble (if available), Jazz Guitar Ensemble
  - **Jazz Guitar** – Jazz Guitar Ensemble
  - **Classical Pianists** – Concert Chorus, Concert Band (only on approval by director), or the Piano Accompanying Class (offered as needed)
  - **Jazz Pianists** – Jazz Combo, Jazz Ensemble (only on approval by director)
  - **Bass Guitarists** – Jazz Combo or Jazz Guitar Ensemble (placement determined by audition)
3. Enroll in MUS 0010 [Recital Seminar](#) (see p. 14).
4. All students taking applied lessons are required to perform in Recital Seminar (or Sophomore Recital) once during each semester\* and perform [Juries](#) at the end of the semester (see p. 8).

\*Except in cases of a teacher exemption during their first semester of taking Applied Lessons.

(“Applied Lesson Grading” on next page.)

## GRADING

Applied lesson grading formats vary from teacher to teacher, except for the following:

- Recital Seminar performance – 25% of applied lesson grade
  - This grade is not based upon the performance itself, but upon the way in which the student prepared for the recital by successfully lining up & rehearsing with an accompanist and submitting the recital performance information to Prof. Gobble in a timely fashion.
- Jury performance – 25% of applied lesson grade
  - This grade is based upon your performance at juries and is an average of all the grades submitted by the teachers present at your jury.

## AUDITIONS

Auditions are held at the beginning of each semester for all new and some returning students who wish to take Applied Lessons. These auditions are usually held the day before classes begin in HU 111. This information should be posted on the class schedule online when you register for classes. Auditions for ensembles and Music Department-related scholarships take place after the semester begins (see [Music Scholarships](#) on p. 12).

## WHO NEEDS TO AUDITION?

- New students wishing to take applied lessons.
- New students wishing to apply for a Music-Department-related scholarship.
- Returning students wishing to take applied lessons on a second instrument.
- Returning students not currently on a Music Department scholarship, but who would like to receive one.

## WHAT TO PLAY

In general, you should be looking to play or sing a piece (or pieces) that best display your overall musicianship as well as your technical facility and sound. Some suggestions are listed below.

### Vocalists

- Choose a song(s) that displays your tone quality, technique & overall musicianship. This may be either classical and/or popular in nature (such as show tunes). An accompanist will be provided for your audition if you wish, but you may bring an accompaniment track an accompaniment track via YouTube or your phone (Bluetooth) if you prefer. if you prefer either via YouTube or your phone (Bluetooth). You may also be asked to vocalize to check your vocal range and/or asked to repeat simple musical patterns.

### Wind Instruments

- Choose an etude or excerpt from the standard repertoire that best showcases the playing level on your instrument. You may want to consider choosing two short excerpts: one that displays your technical facility and one that displays your tone & lyricism. You may also be asked to play some scales as part of your audition.

### Percussion

- Choose etudes or excerpts for each one of the main percussion areas in which you can play: snare drum, timpani, mallets, and/or drum set. If auditioning on snare drum, you may also be asked to play some of the standard rudiments. If auditioning on mallets, you may also be asked to play some scales. If auditioning on drum set, you may be asked to play some basic grooves in the jazz, rock, and Latin styles.

### Classical Guitar

- Choose an etude or excerpt from the standard repertoire that best showcases the playing level on your instrument. You may want to consider choosing two short excerpts: one that displays your technical facility and one that displays your tone & lyricism. You may also be asked to play some scales as part of your audition.



### **Jazz Guitar**

- Choose a song(s) that displays your ability to play in a jazz style. During this selection you should be prepared to play the melody, a brief improvised solo, and the chords that accompany the tune. You may bring an accompaniment track via YouTube or your phone (Bluetooth) if you wish. You may also be asked to play some scales as part of your audition.

### **Classical Piano**

- Perform a memorized selection from the standard repertoire that displays your abilities as a pianist. If you don't have a piece memorized, please bring the music with an appropriate selection prepared. You may be asked to play scales and arpeggios and/or sight read.

### **Jazz Piano**

- Choose a song(s) that displays your ability to play in a jazz style. During this selection you should be prepared to play the melody, a brief improvised solo, and the chords that accompany the tune. You may bring an accompaniment track via YouTube or your phone (Bluetooth) if you wish. You may also be asked to play some scales and chords as part of your audition.

### **Bass Guitar/Jazz Bass**

- Choose a song(s) that displays your ability to play in a jazz style. During this selection you should be prepared to play a walking bass line and the melody (if possible). You may bring an accompaniment track via YouTube or your phone (Bluetooth) if you wish. You may also be asked to play some scales as part of your audition.

## **GRIEVANCE PROCEDURE**

We hope that your experience at Palm Beach State College is a positive and enjoyable one. However, as you pursue your education, it is inevitable that misunderstandings and disagreements will arise from time to time. In general, the procedure outlined below should be followed when you have a misunderstanding or disagreement about a class or Music Department policy. Each step must be completed (in order) before the next one is to be implemented. The process should stop whenever a satisfactory agreement is reached.

1. Talk with the person (student or faculty) with whom the disagreement most directly exists.
2. If the person you spoke with in step #1 is not a faculty member, schedule a time for both of you to meet together with the faculty member in whose class the problem exists, for all three of you to discuss a solution. If the person you spoke with in step #1 is a faculty member, go on to step #3.
3. Schedule a time when everyone concerned in steps #1 and #2 can meet with the Music Department Chairman to discuss a solution.
4. If necessary, the Music Department Chairman will schedule a meeting with the Humanities Division Associate Dean for all concerned parties to arrive at a solution.

## **JURIES**

Juries are end-of-the-semester performances given by all applied music students for music faculty. They are scheduled during finals week of each semester.

### **WHO NEEDS TO ATTEND JURIES?**

ALL students who are registered for Applied Lessons, both Music Pathway and non-Music Pathway.

### **GRADING**

Your jury performance is worth 25% of your final grade for your applied lesson, so it is important to prepare for this performance carefully.

## WHAT TO PREPARE

### Wind Instruments

- Perform an etude or piece of your choice that best displays what you have worked on over the course of the semester.
  - If the piece is short, a second selection may be performed (at the discretion of the music faculty).
- Students may also be asked to perform scales, chords, or arpeggios appropriate to their instrument and playing level.
- Students who wish to have piano accompaniment for their selection(s) need to line up an accompanist beforehand and sign up for a jury time that their accompanist can attend.

### Percussion

- Perform an etude or piece of your choice that best displays what you have worked on over the course of the semester.
  - If the piece is short, a second selection may be performed (at the discretion of the music faculty).
- Students may also be asked to perform scales, chords, or arpeggios appropriate to their instrument and playing level.

### Vocalists

- Vocalists should be prepared to perform any of the songs studied during the semester by memory.
  - The student will select one song and the faculty will select one or two more.
- Students may be asked to demonstrate vocal exercises or vocalises that they have worked on.
- Students who wish to have piano accompaniment for their selections need to line up an accompanist beforehand and sign up for a jury time that their accompanist can attend.

### Classical Guitarists

- Perform an etude or piece of your choice that best displays what you have worked on over the course of the semester.
  - If the piece is short, a second selection may be performed (at the discretion of the music faculty).
- Students may also be asked to perform scales, chords, or arpeggios appropriate to their instrument and playing level.

### Classical Pianists

- Perform an etude or piece of your choice that best displays what you have worked on over the course of the semester.
  - If the piece is short, a second selection may be performed (at the discretion of the music faculty).
- Students may also be asked to perform scales, chords, or arpeggios appropriate to their instrument and playing level. Pianists will perform their piece(s) from memory.

### Jazz Guitarists & Pianists

- Perform a piece of your choice (by memory) that best displays what you have worked on over the course of the semester.
- Students may also be asked to perform scales, chords, or arpeggios appropriate to their instrument and playing level.

## JURY SIGN-UP

Jury sign-up sheets will be posted one to two weeks before finals on the large bulletin board in the lobby. Students should sign up for one ten-minute slot once they are certain of their final exam schedule.

("Jury Evaluations" on next page.)

## JURY EVALUATIONS

Each music faculty member present will provide a critique and a grade in writing. These grades are averaged to arrive at your jury grade. You will receive these written comments at the end of your jury. Sound, Intonation, Technique, Articulation, Rhythmic Accuracy, Breath Control, Phrasing & Expression, as well as Overall Musicality are some of the elements that will be considered in your evaluation.

## LOCKERS

The lockers that are located in the practice room area will be available for students' use throughout the school year. A sign-up for locker use will take place during the first week of classes each semester. Instrumental students who would like to store their cases in a locker will get priority. \*

- Locker procurement procedure:
  - See Prof. Gible in HU 125 to be assigned a locker number.
  - Go to the Humanities office (HU 126) to sign out a locker key. No fee is involved.
    - Students are required to turn in their key during Finals week in May after juries.
    - Students NOT returning the key will have their records put on hold until the key is returned or be assessed a fee for replacement of the key if lost.

\*Guitar & bass guitar students will share a locker that can accommodate their cases for daily storage.

## MUSIC ENSEMBLES

Music Ensembles meet as one-credit classes. They are open to ALL students regardless of their Pathway area of concentration. Ensembles are a required co-requisite for all students taking [Applied Lessons](#)\* regardless of their Pathway. Students may take additional ensembles for personal interest or enrichment if they choose. Contact David Gible at [gibbled@palmbeachstate.edu](mailto:gibbled@palmbeachstate.edu) or 561-868-3266 if interested in participating in an any ensemble.

\*Required ensembles for [Applied Lesson](#) students according to their principal instrument

- Vocalists – Concert Chorus (MUN 1310)
- Wind Instruments and Percussion – Concert Band (MUN 1120)
- Classical Guitar – Classical Guitar Ensemble (MUN 1492; if available)
- Jazz Guitar – Jazz Guitar Ensemble (MUN 1710 E)
- Pianists and Bassists – assigned an ensemble as appropriate

## VOCAL ENSEMBLE

**Concert Chorus (MUN 1310)** – a large vocal ensemble (25-40 members) which performs choral literature from the Medieval period through contemporary compositions. This class covers vocal technique, music learning, and ensemble singing skills, as well as musical interpretation and performance.

- Registration in this class is required for all applied voice students and recommended as a choice for applied piano students.
- Meets Mondays & Wednesdays from at 11 AM–12:15 PM
- No audition required

## INSTRUMENTAL ENSEMBLES

**Concert Band (MUN 1120)** – a large instrumental ensemble (35-50 members) which performs standard band literature from the Renaissance period through contemporary compositions. This class strongly emphasizes music reading and interpretation of musical styles.

- Registration in this class is required for all applied instrumental students except piano, guitar, and bass guitar.
- Meets Monday evenings from 7-9 PM
- Audition required

**Jazz Combo (MUN 1710 C)** – a small ensemble (4-10 musicians) which performs classic jazz compositions and standards from the American song book through today's contemporary jazz literature. This class strongly emphasizes improvisation and interpretation of jazz styles.

- Meets Tuesdays & Thursdays from 2-3:15 PM; other times on Tuesday & Thursday as needed
- Audition required

**Tuesday Nite Band (MUN 1710 D)** – a medium-sized big band (14-18 instrumentalists) which performs advanced jazz literature encompassing a variety of styles. This class strongly emphasizes music reading and interpretation of advanced jazz styles, as well as improvisation.

- Meets Tuesday evenings from 7-9 PM
- Audition required

**Jazz Guitar Ensemble (MUN 1710 E)** – a small ensemble (4-10 instrumentalists) which performs classic jazz compositions and standards from the American song book. This class strongly emphasizes music reading, improvisation, and interpretation of jazz styles.

- Registration in this class is required for all applied jazz guitar students
- Meets Tuesdays & Thursdays from 5-6:15 PM
- Audition required

**OTHER ENSEMBLES** – the following are offered based upon student interest & enrollment.

**Woodwind Ensemble (MUN 1420)** – a chamber ensemble (4-10 instrumentalists) which performs standard woodwind literature. This class may meet as a flute ensemble, clarinet ensemble, woodwind quintet, or as an ensemble of mixed woodwind instrumentation. It emphasizes music reading and the development of technique, as well as the interpretation of musical styles.

- Meeting time to be arranged
- Audition required

**Brass Ensemble (MUN 1430)** – a chamber ensemble (4-10 instrumentalists) which performs standard brass literature. This class may meet as a trumpet ensemble, brass quartet, brass quintet, or as an ensemble of mixed brass instrumentation. It emphasizes music reading and the development of technique, as well as the interpretation of musical styles.

- Meeting time to be arranged
- Audition required

**Classical Guitar Ensemble (MUN 1492)** – a small ensemble (4-6 instrumentalists) which performs music from the Renaissance, Baroque, Classical, Romantic, and Modern eras that was originally written for or transcribed for multiple guitars. It emphasizes music reading and the development of technique, as well as the interpretation of musical styles.

- Registration in this class is required for all applied classical guitar students
- Meeting time to be arranged
- Audition required

**12 O'clock Jazz Ensemble (MUN 1710 A)** – a medium-sized big band (14-18 instrumentalists) which performs compositions encompassing a variety of jazz styles. This class strongly emphasizes music reading and the interpretation of jazz styles as well as some improvisation.

- Meets Tuesdays & Thursdays from 12:30-1:45 PM
- Audition required

("Musical Ensembles" continued on next page.)

**Troubadours (MUN 1720)** – is a chamber jazz vocal ensemble (4-10 vocalists) which performs standard jazz literature, show tunes, and popular music from the American song book. This class focuses on the vocal, musical, and interpretive skills necessary for performing vocal jazz (both ensemble and solo). In addition to good vocal technique, students need strong music skills in both ensemble singing and music reading/learning.

- Meets Mondays & Wednesdays from 2-3:15 PM
- Audition required (auditions in the Fall only)
  - Acceptance in this group is contingent on a yearly commitment (Fall & Spring semesters)
- May be open to selected instrumentalists (usually bass, drums, guitar)

**Chamber Singers (MUN 2340)** – a small-to-medium size vocal ensemble (10-16 vocalists) for experienced singers which offers practical experience in the study and performance of sacred and secular repertoire for the vocal chamber ensemble. Classical music from the Renaissance through the twentieth century including both a cappella and accompanied works is studied.

- Meeting time to be arranged
- Audition required

**Piano Instrumental/Vocal Accompanying (MUN 2510)** – this class covers skills in playing piano chamber music (duets, trios, etc.) and in accompanying vocalists and/or instrumentalists in solo and/or ensemble performance. It emphasizes music reading and the interpretation of musical styles, as well as skills in playing with and following others.

- Meeting time to be arranged
- Audition required

## MUSIC SCHOLARSHIPS

All of the following scholarships\* are determined through auditions held in the second or third week of classes in each fall and spring semester. Contact the faculty or check the Music Department website for specific dates and information.

**\*Students who wish to be considered for any type of scholarship must FIRST apply to the PBSC Foundation at <https://www.palmbeachstate.edu/foundation/student-scholarships/foundation-faq.aspx>. This MUST be done before the deadline in AUGUST in order to be eligible for any scholarship in the upcoming school year. Students who do not apply will NOT be eligible for scholarships.**

(“Scholarship Requirements” on next page.)

## SCHOLARSHIP REQUIREMENTS

### General Music Department Scholarship

- Must be a full-time student (12 semester hrs. minimum) with a specialization in music. This would include taking the Music Theory and Ear Training/Sight Singing cycle of classes (levels I-IV for each class).
- Register for and participate in at least one Palm Beach State-Lake Worth [Musical Ensemble](#). Ensemble participation is required each subsequent semester for scholarship renewal.
  - **Instrumentalists (except piano)** must take Concert Band.
  - **Vocalists** must take Concert Chorus.
  - **Pianists** must take either Concert Chorus, Concert Band (on approval by director) or the Piano Accompanying Class (offered as needed)
  - **Guitarists** must take Guitar Ensemble (classical or jazz).
- Take private [Applied Lessons](#) in voice or major instrument of your choice, with a minimum grade of B required for scholarship renewal.
- Register for and attend [Recital Seminar](#) (MUS 0010, W 12:30-1:20)
- Perform in a student recital each semester (including the first semester) in which you are receiving a scholarship.
- Achieve and maintain cumulative minimum grade point averages (GPAs) of 2.5 in overall coursework, and 3.0 in music coursework.
- Meet with a music faculty member for advisement on scheduling and receive that faculty member's signature of schedule approval on the intended schedule.
- Students will be notified of Music Department scholarship awards by email.

### Dr. Charles Colbert Scholarship

- Must be a Music Pathway student enrolled in the PBSC Concert Band.
- Student must have financial need as determined by FASFA (Free Application for Federal Student Aid form).
- Achieve and maintain cumulative minimum grade point averages (GPAs) of 2.5 in overall coursework, and 3.0 in music coursework.
- Recipients are selected by the Music Department.
- Students will be notified of Dr. Charles Colbert scholarship awards by email.

### Nick Nicholson Scholarship

- It is open to Music Pathway and non-Music Pathway instrumental students taking 9 or more credits.
- Students must possess and maintain a 3.0 minimum GPA.
- Participate in instrumental ensembles where applicable as determined by audition.
- Students will be notified of Nick Nicholson scholarship awards by email.

### Paul Chafin Scholarship

- Must be a Music Pathway student enrolled in a minimum of 9 semester hrs.
  - This includes taking courses within the Music Theory and Ear Training/Sight Singing cycle of classes (levels I-IV for each class).
- Register for and participate in at least one Palm Beach State-Lake Worth jazz ensemble.
  - Jazz Combo, Jazz Guitar ensemble and/or Jazz Ensemble (big band).
  - Ensemble participation is required each subsequent semester for scholarship renewal.
- Take private applied lessons on your major instrument of your choice, with a minimum grade of B required for scholarship renewal.
- Achieve and maintain cumulative minimum grade point averages (GPAs) of 2.5 in overall coursework, and 3.0 in music coursework.
- Audition for Music faculty. (Audition requirements on next page.)

- Wind Instruments
  - Perform a jazz etude or transcription of your own choice.
  - Play melody and improvise over one of the following tunes:
    - “Now’s the Time” – one chorus melody, two choruses of solo
    - “Satin Doll” – one chorus melody, one chorus of solo
    - “Take the A Train” – one chorus melody, one chorus of solo
- Piano/Guitar/Bass/Drums
  - Perform a jazz etude or transcription of your own choice.
  - Play melody, comp (or walk), and improvise over one of the following tunes:
    - “Now’s the Time” – one chorus melody, one chorus comp/walk; two choruses of solo
    - “Satin Doll” – one chorus melody, one chorus comp/walk, one chorus solo
    - “Take the A Train” – one chorus melody, one chorus comp/walk, one chorus solo
- Students will be notified of the Paul Chafin scholarship award by email.

## PERFORMANCES

Most musical ensembles have at least two performances scheduled for each semester. Large ensembles normally play one performance at the Duncan Theatre on the Lake Worth campus and one at the Eissey Campus Theatre on the Palm Beach Gardens campus each semester. Smaller ensembles perform primarily on the Lake Worth campus in HU114 or Stage West. These performances are scheduled toward the end of the semester, so it is necessary to plan your outside activities accordingly.

Students enrolled in performance ensembles are required\* to participate in each concert and the accompanying sound check which is usually scheduled 1½-2 hours before the start of the performance. Students are also expected to make accommodations to avoid potential conflicts of outside commitments with these performance dates (such as work conflicts).

\*Failure to participate in the concerts may result in the lowering of your final grade by one or more letter grade(s).

## PRACTICE ROOMS

Practice rooms are available for your use during regular weekday school hours, which are 7:30 AM until 9:00 PM. Sign-up sheets are posted on the doors to each practice room and each student is permitted to sign up for a maximum of two hours per day. Additional practice time is available if a practice room is not reserved when you wish to practice, or if it is reserved and the scheduled person is more than ten minutes late.

- Practice rooms are not available for use when classes are not in session due to student holidays, Academic Development days, or other class cancellations/campus closings due to special circumstances.
- There are two practice rooms with special designations:
  - One contains percussion equipment and is designated for percussion students only.
  - One contains a grand piano and is reserved for piano majors and some applied lessons (voice).
- Non-piano majors may also practice in the Keyboard Lab (HU 203) during open lab hours.

## RECITAL SEMINAR

Recital Seminar (MUS 0010) is a weekly class that meets on Wednesdays from 12:30 to 1:20, in HU 111, HU 114, or Stage West, depending on the physical needs for the lecture or performance scheduled for that week. The class is worth zero (0) credits, but excessive absences will affect your Applied Lesson grade as listed on next page.



### WHO NEEDS TO ATTEND?

ALL students who are taking applied lessons are REQUIRED to attend, regardless of Pathway, since Recital Seminar is a co-requisite of Applied Lessons.

### WHAT TYPE OF ACTIVITIES TAKE PLACE?

A variety of activities, which change from semester to semester, take place during Recital Seminar:

- Lectures/Discussions/Presentations led by Palm Beach State Music faculty or visiting guests
- Performances by professional artists
- Performances by Palm Beach State ensembles
- Solo performances by Palm Beach State students toward the end of the semester

### GRADING

Since Recital Seminar is a zero (0) credit class; no grade is assigned to students for the class. HOWEVER, having more than three unexcused absences will result in the lowering of your final Applied Lesson grade, since this class is a co-requisite for applied lessons.

- Four unexcused absences –lowered one letter grade
- Five unexcused absences – lowered two letter grades, etc.

### SOPHOMORE RECITAL

Sophomore Recital is an opportunity to showcase our graduating music students in a special evening recital for a public audience. The recital usually takes places on an evening before finals of the spring semester of each year.

Students who are invited to perform include students who will be graduating...

- at the end of the spring semester.
- at the end of the following summer A or B session.
- at the end of the next fall semester.

(“Keys to Success” on next page.)



## KEYS TO SUCCESS

### **Attend all class sessions.**

- Be punctual, and don't leave early.

### **Stay alert in class.**

### **Take good notes.**

- Don't worry so much about writing down every word that you forget to think and listen critically.

### **Print out, read and keep the syllabus.**

- It often lists dates for tests and gives detailed instructions for completing assigned projects.

### **Read the textbook.**

- Try reading ahead of assignments when possible.

### **Complete assigned homework on time.**

- Play or sing your work before finalizing your answers or turning in homework.

### **Use the music tutorial software available in the Keyboard Lab or free tutorial programs at home.**

### **Relate different courses to each other.**

- If you're discussing key signatures in Music Theory, figure out the key for all the pieces in your Applied Lessons or Concert Band folder.
  - Instrumentalists should sight-sing each new applied lesson piece.
  - Vocalists should analyze the piano accompaniment for songs in Concert Chorus.

### **Work with each other.**

- Find a partner in your class and schedule times to meet with each other during the week to practice music for sight-singing classes or ensembles.
  - Perform your applied music pieces for each other.
  - Play your Class Piano assignments together, holding each other accountable for keeping up with assignments.

### **See your teacher when you think you have it right, but you're not quite sure.**

- Don't wait until you're hopelessly lost.

### **Make a 24-hour, 7-day schedule showing everything you do.**

- Include work, eating, sleeping, cleaning, driving, television, socializing, etc.
- Try to schedule **two** hours of study or practice for every (**one**) hour of class time.
  - If it doesn't work, maybe you need to reduce or eliminate non-school activities.

Keep in mind that college is a temporary situation – you won't have to make these sacrifices forever. After all, if earning a college degree were easy, a lot more people would have one!

(“Humanities Building Room Maps” on next page.)

# HUMANITIES BUILDING ROOM MAPS

## FIRST FLOOR

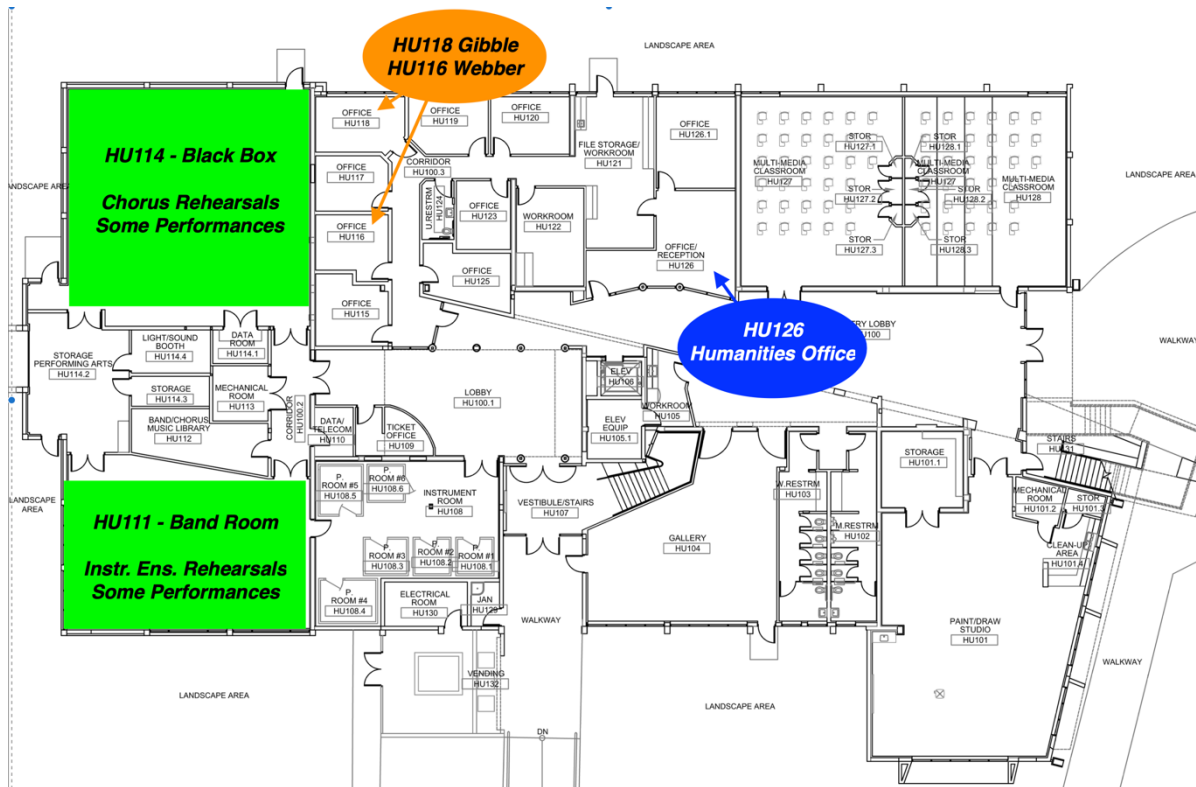

## SECOND FLOOR

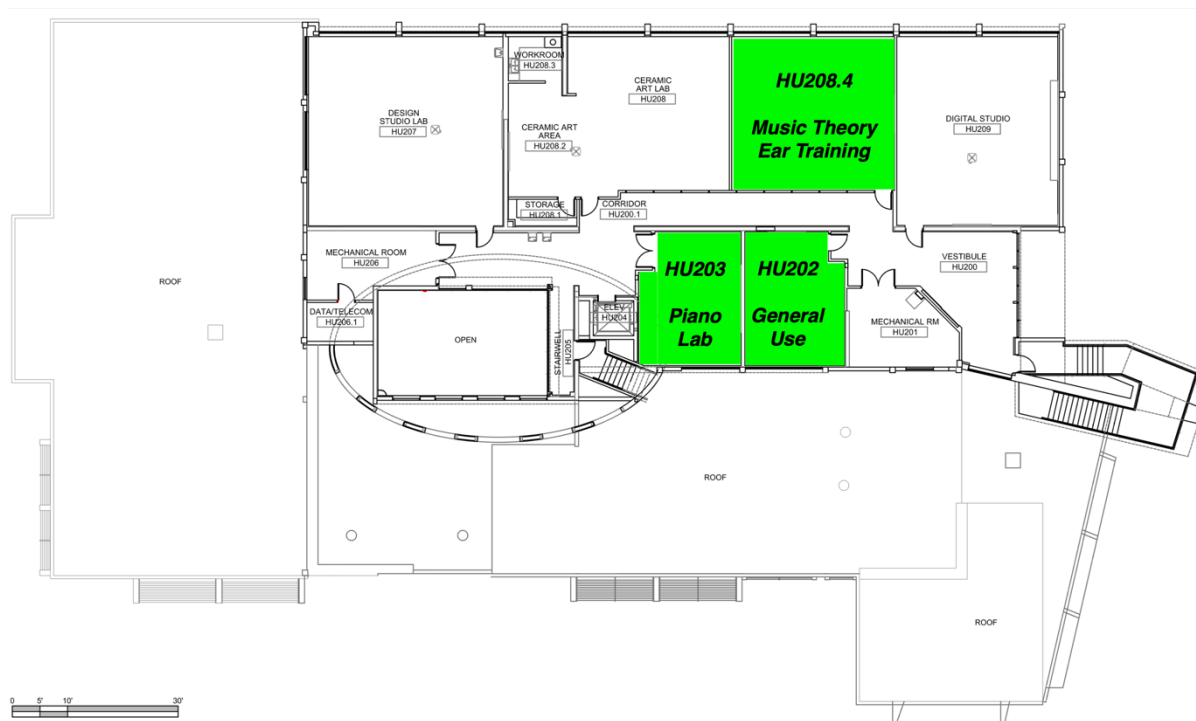

[Click Here for Music Career Pathway Link](#)

## CAMPUS MAP

PALM BEACH STATE COLLEGE AT LAKE WORTH

**4200 Congress Avenue, Lake Worth, FL 33461-4796**

**561-967-7222**

