

109.690

Wooden Star "Cosmos" with LED Lighting

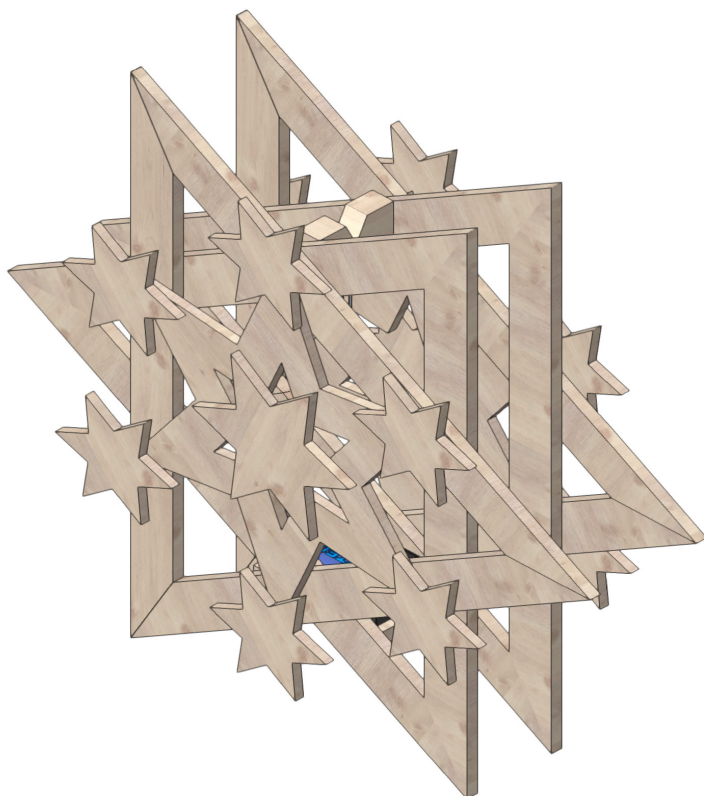
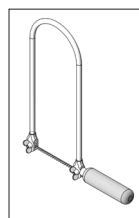
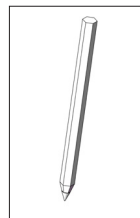

Tools Required:

jigsaw/
scroll saw

pencil

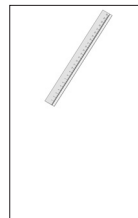

ruler

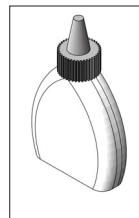

wood glue

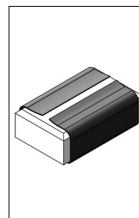

sandpaper

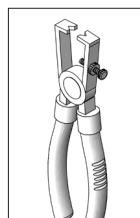

wire stripper

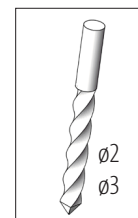

drill

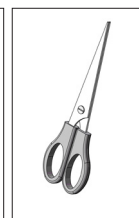

scissors

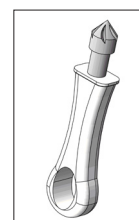

countersink

Please Note!

The OPITEC range of projects is not intended as toys for young children. They are teaching aids for young people learning the skills of Craft, Design and Technology. These projects should only be undertaken and operated with the guidance of a fully qualified adult. The finished projects are not suitable to give to children under 3 years old. Some parts can be swallowed. Danger of suffocation!

Parts List	Quantity	Size (mm)	Designation	Part No.
wooden strip	12	250x20x5	triangle leg	1
wooden strip	1	100x30x10	spacer	2
plywood	1	300x210x4	deco stars	3
LED	1	5	lighting	4
electric wire	1	500	wiring	5
battery holder	1		power source	6
micro slide switch	1		switch	7
chipboard screws	6	ø3x12	attachment	8
thumbtacks	2		LED attachment	9
wooden strip	1	100x10x5	spacer	10

Instruction 109.690
Wooden Star "Cosmos" with LED Lighting

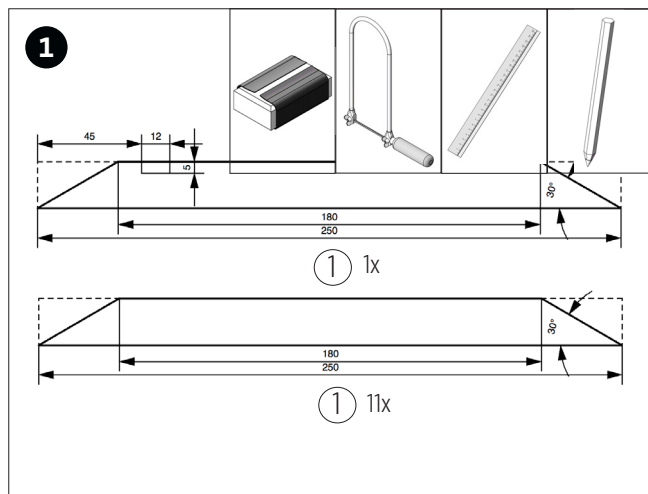

Bevel the 12 wooden strips (1) as shown. Mark the recess for the switch on a wooden strip and saw it out. Clean the saw cuts. Note: Save 2 waste pieces for fixing the spacers..

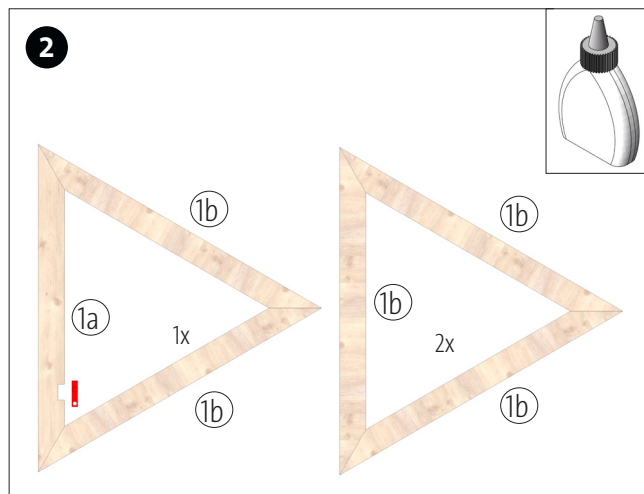

Glue the strips (1) together as shown. Then glue in the switch (7).

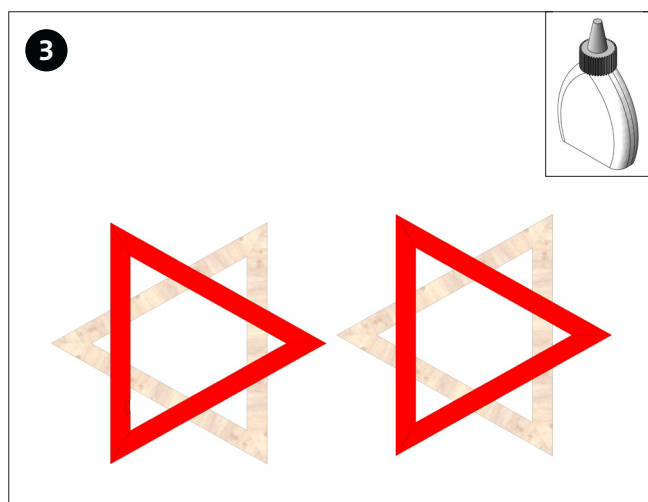

Glue the resulting triangular frames together as shown.

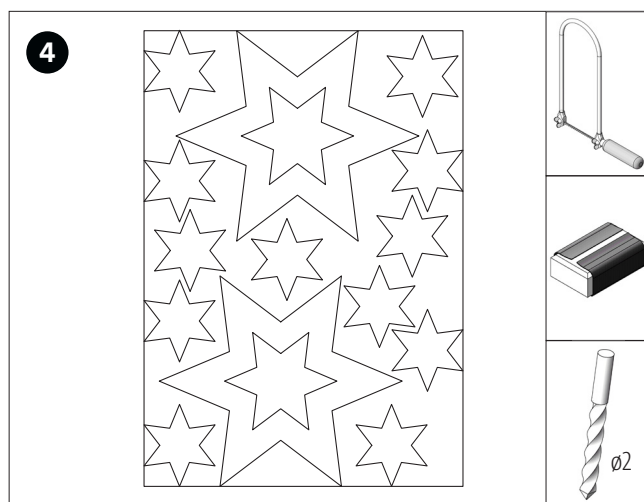

Transfer the template of the stars (page 5) to the plywood (3). 12 small and 2 big stars are needed. Distribution see picture! Saw out all stars and clean all saw cuts.

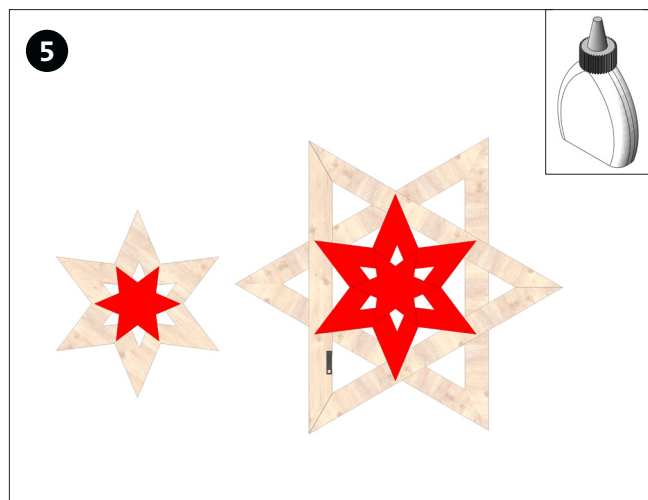

Attach the middle deco stars to both glued frames as shown (step 3).

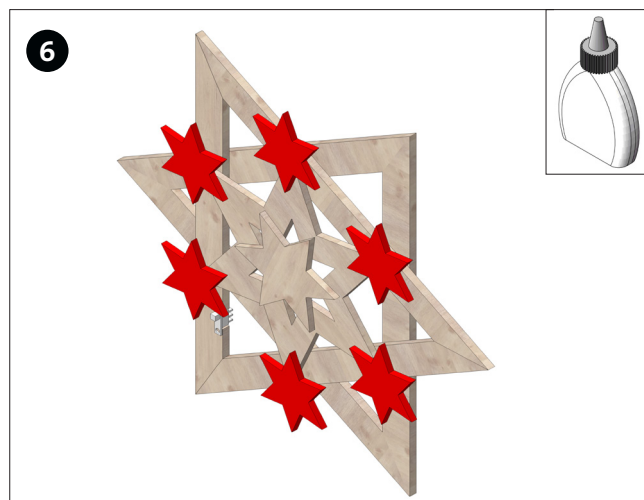

Place and fix the small stars as illustrated.

Instruction 109.690
Wooden Star "Cosmos" with LED Lighting

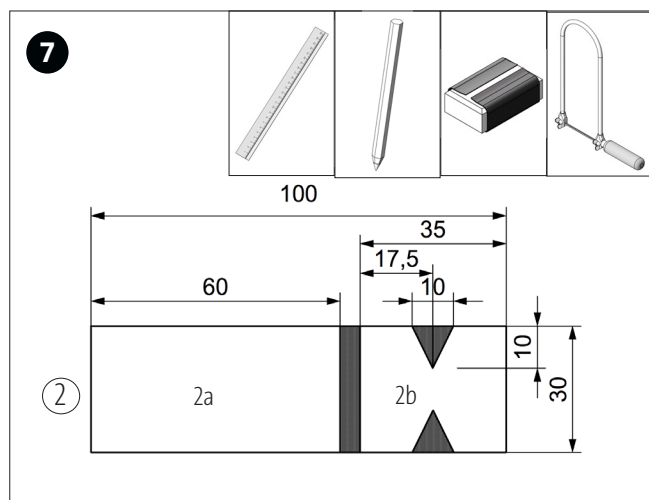

Cut the wooden strip (2) to size and notch it. Clean the saw cuts.

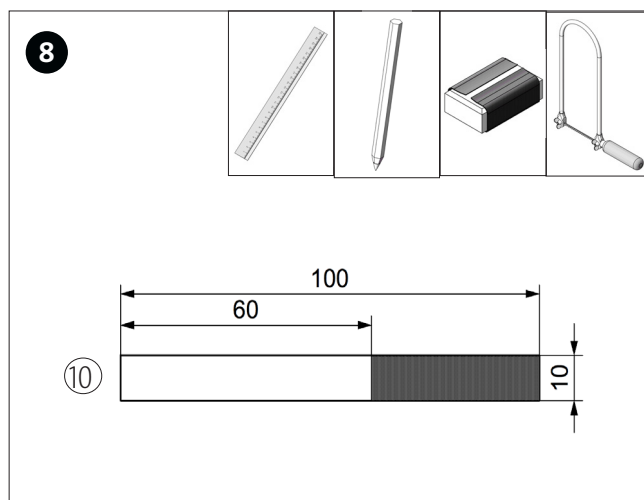

Cut the wooden strip (10) to size and clean the saw cuts.

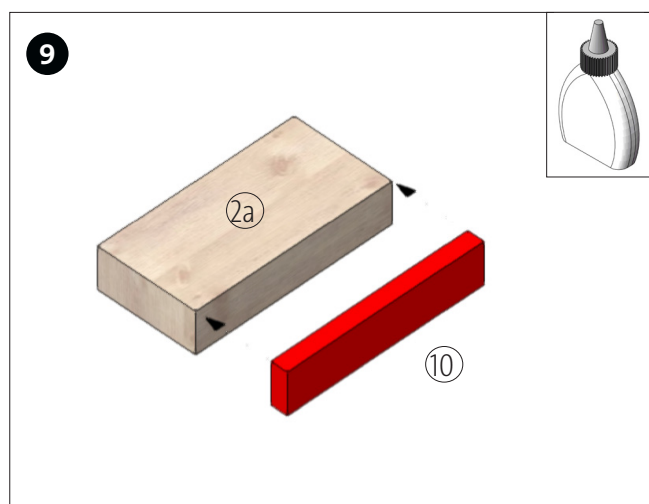

Glue the wooden strip 10 to part 2a. Let the glue dry well.

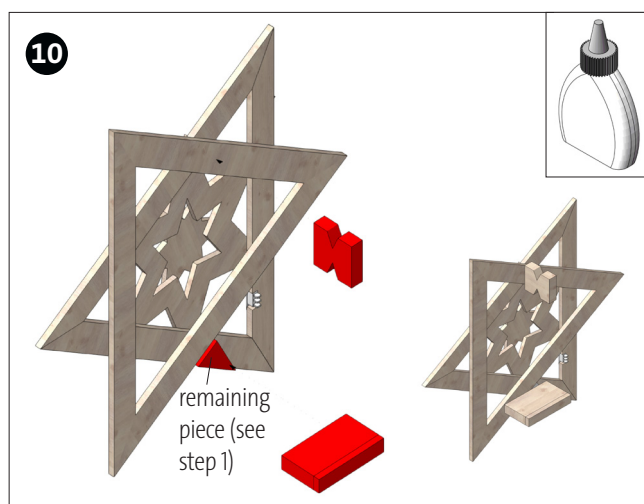

Glue a remaining piece from step 1 as well as the spacers (2a+2b) to the frame as shown. Attach the second remaining piece to the second frame in the same way. Allow the glue to dry well.

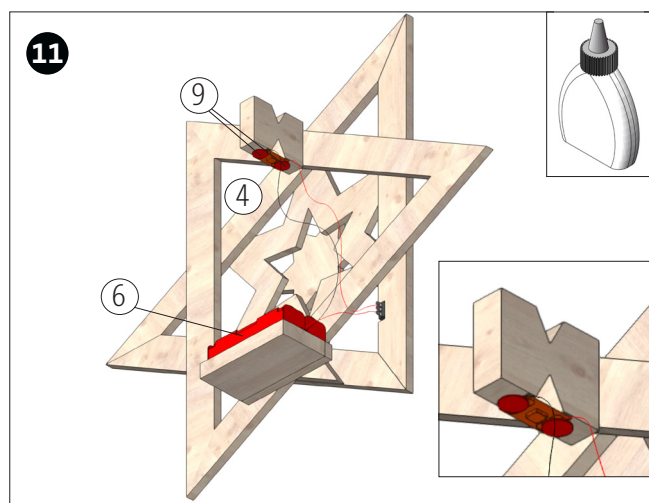

Connect the red cable of the battery holder to the middle pole of the slide switch. To do this, wrap the end of the cable firmly around the pole. Make sure that there is no contact to another pole of the switch.

Connect the black cable of the battery holder to the cathode (short leg, flattened side) of the LED (4). To do this, wrap the cable tightly around the leg and fasten the leg with the cable to the underside of the upper spacer using a thumbtack (9) (see illustration).

Cut an approx. 100 mm long piece of the wire (5) and strip the insulation on both sides. Then attach one end to a free pole of the slide switch. Wrap the other end around the anode of the LED (4) and fix it with a thumbtack to the underside of the upper spacer (see illustration).

Insert the battery and check its function.

Instruction 109.690
Wooden Star "Cosmos" with LED Lighting

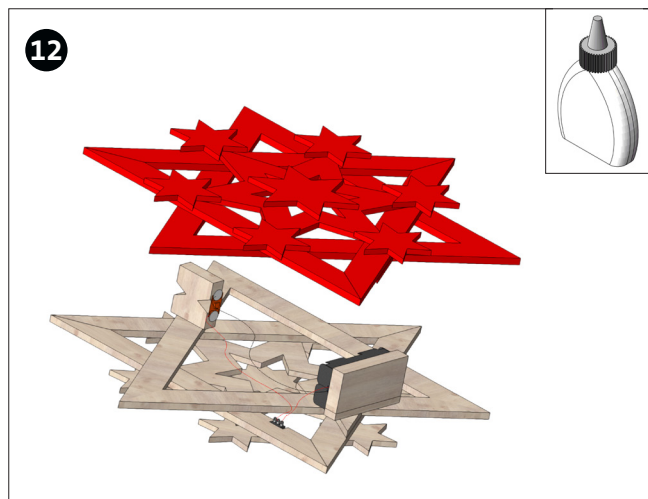

Then glue the second half of the star mirror-inverted and congruently onto the spacers.
Let the glue dry well!

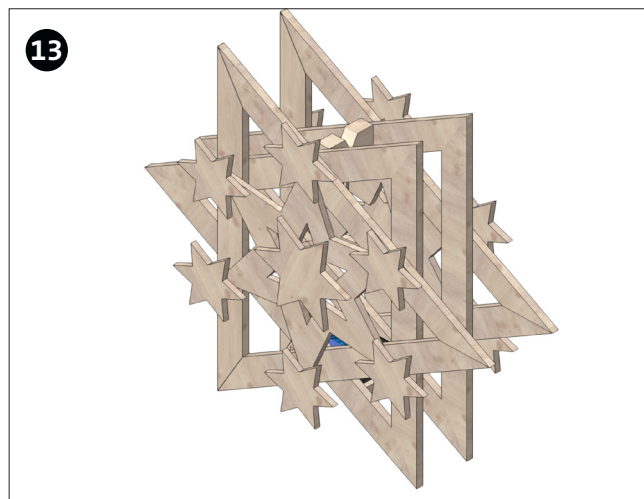

This Christmas star can easily be placed or hung up with a thread.

Instruction 109.690
Wooden Star "Cosmos" with LED Lighting

